

STRUCTURAL SHAPES

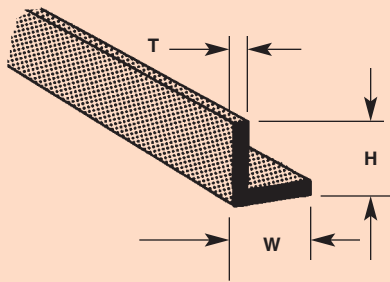

TRADITIONAL ABS ANGLES

Use for bracing in the construction of heavy steel structures, and vertical support legs in light structures. Precision Injection Molded in Dark Gray ABS Plastic. Ideal for all outdoor or professional model construction where model life is critical. High impact characteristics provide durability, flexibility and longevity of the model.

CODE	ACTUAL SIZE						LENGTH	
	'H'		'W'		'T'			
A-1	3/64"	1.2mm	3/64"	1.2mm	.015	0.4mm	10"	250mm
A-2	1/16"	1.6mm	1/16"	1.6mm	.020	0.5mm	10"	250mm
A-3	3/32"	2.4mm	3/32"	2.4mm	.025	0.6mm	15"	375mm
A-4	1/8"	3.2mm	1/8"	3.2mm	.030	0.8mm	15"	375mm
A-6	3/16"	4.8mm	3/16"	4.8mm	.065	1.7mm	24"	600mm
A-8	1/4"	6.4mm	1/4"	6.4mm	.065	1.7mm	24"	600mm
A-10	5/16"	7.9mm	5/16"	7.9mm	.065	1.7mm	24"	600mm
A-12	3/8"	9.5mm	3/8"	9.5mm	.065	1.7mm	24"	600mm

FINELINE STYRENE ANGLES

Use for bracing in the construction of heavy steel structures, and vertical support legs in light structures. Precision Extruded in White Styrene Plastic. Ideal for museum quality and smaller scale model construction where assembly speed, profile accuracy and cost are the determining factors.

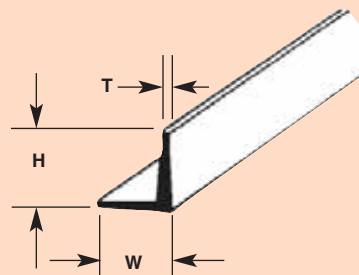

CODE	ACTUAL SIZE						LENGTH	
	'H'		'W'		'T'			
AFS-0	1/32"	0.8mm	1/32"	0.8mm	.010	0.3mm	10"	250mm
AFS-1	3/64"	1.2mm	3/64"	1.2mm	.015	0.4mm	10"	250mm
AFS-2	1/16"	1.6mm	1/16"	1.6mm	.020	0.5mm	10"	250mm
AFS-3	3/32"	2.4mm	3/32"	2.4mm	.025	0.6mm	15"	375mm
AFS-4	1/8"	3.2mm	1/8"	3.2mm	.030	0.8mm	15"	375mm
AFS-6	3/16"	4.8mm	3/16"	4.8mm	.030	0.8mm	24"	600mm
AFS-8	1/4"	6.4mm	1/4"	6.4mm	.035	0.9mm	24"	600mm
AFS-10	5/16"	7.9mm	5/16"	7.9mm	.035	0.9mm	24"	600mm
AFS-12	3/8"	9.5mm	3/8"	9.5mm	.045	1.1mm	24"	600mm

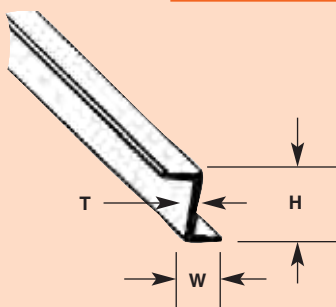

FINELINE STYRENE ZEE BAR

Use for bracing or brackets in the construction of most steel structures. Precision Extruded in White Styrene Plastic. Ideal for museum quality and smaller scale model construction where assembly speed, profile accuracy and cost are the determining factors.

CODE	ACTUAL SIZE						LENGTH	
	'H'		'W'		'T'			
ZFS-2	1/16"	1.6mm	.039	1.0mm	.015	0.4mm	10"	250mm
ZFS-3	3/32"	2.4mm	.057	1.4mm	.020	0.5mm	10"	250mm
ZFS-4	1/8"	3.2mm	.077	2.0mm	.030	0.8mm	15"	375mm
ZFS-6	3/16"	4.8mm	.108	2.7mm	.030	0.8mm	15"	375mm
ZFS-8	1/4"	6.4mm	.145	3.7mm	.040	1.0mm	24"	600mm

STRUCTURAL SHAPES

TRADITIONAL ABS TEES

Use for bracing in the construction of most steel structures. Precision Injection Molded in Dark Gray ABS Plastic. Ideal for all outdoor or professional model construction where model life is critical. High impact characteristics provide durability, flexibility and longevity of the model.

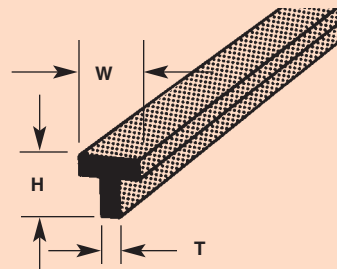

CODE	ACTUAL SIZE						LENGTH	
	'H'		'W'		'T'			
T-1	3/64"	1.2mm	3/64"	1.2mm	.015	0.4mm	10"	250mm
T-2	1/16"	1.6mm	1/16"	1.6mm	.020	0.5mm	10"	250mm
T-3	3/32"	2.4mm	3/32"	2.4mm	.030	0.8mm	15"	375mm
T-4	1/8"	3.2mm	1/8"	3.2mm	.040	1.0mm	15"	375mm
T-6	3/16"	4.8mm	3/16"	4.8mm	.060	1.5mm	24"	600mm
T-8	1/4"	6.4mm	1/4"	6.4mm	.060	1.5mm	24"	600mm

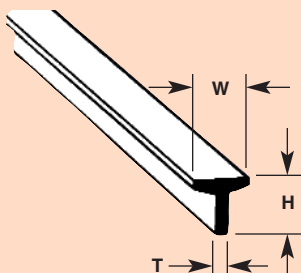

FINELINE STYRENE TEES

Use for bracing in the construction of most steel structures. Precision Extruded in White Styrene Plastic. Ideal for museum quality and smaller scale model construction where assembly speed, profile accuracy and cost are the determining factors.

CODE	ACTUAL SIZE						LENGTH	
	'H'		'W'		'T'			
TFS-1	3/64"	1.2mm	3/64"	1.2mm	.015	0.4mm	10"	250mm
TFS-2	1/16"	1.6mm	1/16"	1.6mm	.020	0.5mm	10"	250mm
TFS-3	3/32"	2.4mm	3/32"	2.4mm	.030	0.8mm	15"	375mm
TFS-4	1/8"	3.2mm	1/8"	3.2mm	.040	1.0mm	15"	375mm
TFS-6	3/16"	4.8mm	3/16"	4.8mm	.030	0.8mm	24"	600mm
TFS-8	1/4"	6.4mm	1/4"	6.4mm	.035	0.9mm	24"	600mm

FINELINE STYRENE DEEP CHANNELS

Use for bracing or medium weight horizontal and vertical support members in the construction of most steel structures. Precision Extruded in White Styrene Plastic. Ideal for museum quality and smaller scale model construction where assembly speed, profile accuracy and cost are the determining factors.

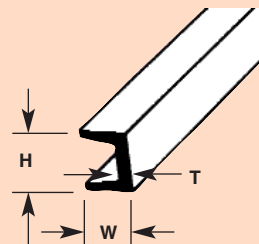

CODE	ACTUAL SIZE						LENGTH	
	'H'		'W'		'T'			
UFS-2	1/16"	1.6mm	.043	1.1mm	.015	0.4mm	10"	250mm
UFS-3	3/32"	2.4mm	.065	1.7mm	.025	0.6mm	10"	250mm
UFS-4	1/8"	3.2mm	.089	2.3mm	.030	0.8mm	15"	375mm
UFS-6	3/16"	4.8mm	.135	3.4mm	.030	0.8mm	15"	375mm
UFS-8	1/4"	6.4mm	.180	4.6mm	.040	1.0mm	24"	600mm

TIP:

For fast, clean, accurate cutting of Styrene Shapes, Tubing, Strip and Rod, simply scribe with a hobby knife and snap. When cutting Sheet Styrene, make all scribes first and then bend downward one side at a time until it snaps clean.

TRADITIONAL ABS I-BEAMS

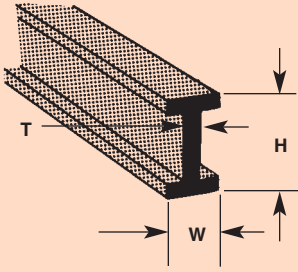

Use for horizontal or diagonal members in the construction of most steel structures. Precision Injection Molded in Dark Gray ABS Plastic. Ideal for all outdoor or professional model construction where model life is critical. High impact characteristics provide durability, flexibility and longevity of the model.

CODE	ACTUAL SIZE						LENGTH	
	'H'		'W'		'T'			
B-2	1/16"	1.6mm	1/32"	0.8mm	.015	0.4mm	10"	250mm
B-3	3/32"	2.4mm	3/64"	1.2mm	.020	0.5mm	10"	250mm
B-4	1/8"	3.2mm	1/16"	1.6mm	.025	0.6mm	15"	375mm
B-6	3/16"	4.8mm	3/32"	2.4mm	.050	1.3mm	24"	600mm
B-8	1/4"	6.4mm	1/8"	3.2mm	.050	1.3mm	24"	600mm
B-10	5/16"	7.9mm	5/32"	4.0mm	.060	1.5mm	24"	600mm
B-12	3/8"	9.5mm	3/16"	4.8mm	.060	1.5mm	15" •	375mm
B-14	7/16"	11.1mm	7/32"	5.6mm	.060	1.5mm	15" •	375mm
B-16	1/2"	12.7mm	1/4"	6.4mm	.080	2.0mm	15" •	375mm
B-18	9/16"	14.3mm	1/4"	6.4mm	.080	2.0mm	15" •	375mm
B-20	5/8"	15.9mm	1/4"	6.4mm	.080	2.0mm	15" •	375mm
B-24	3/4"	19.1mm	5/16"	7.9mm	.080	2.0mm	15" •	375mm
B-28	7/8"	22.2mm	3/8"	9.5mm	.085	2.2mm	15" •	375mm
B-32	1"	25.4mm	3/8"	9.5mm	.085	2.2mm	15" •	375mm
B-36	1-1/8"	28.6mm	1/2"	12.7mm	.090	2.3mm	15" •	375mm

NOTE:

- These Products are also available at double the shown length for twice the listed price. Just add 'L' to the end of the Product Code. Example: B-18L

FINELINE STYRENE I-BEAMS

Use for horizontal or diagonal members in the construction of most steel structures. Precision Extruded in White Styrene Plastic. Ideal for museum quality and smaller scale model construction where assembly speed, profile accuracy and cost are the determining factors.

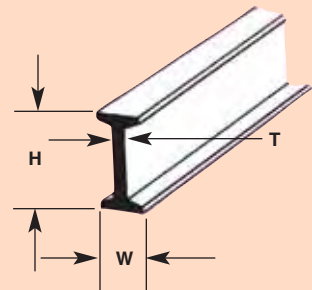

CODE	ACTUAL SIZE						LENGTH	
	'H'		'W'		'T'			
BFS-2	1/16"	1.6mm	1/32"	0.8mm	.015	0.4mm	10"	250mm
BFS-3	3/32"	2.4mm	3/64"	1.2mm	.020	0.5mm	10"	250mm
BFS-4	1/8"	3.2mm	1/16"	1.6mm	.025	0.6mm	15"	375mm
BFS-5	5/32"	4.0mm	5/64"	2.0mm	.030	0.8mm	15"	375mm
BFS-6	3/16"	4.8mm	3/32"	2.4mm	.035	0.9mm	24"	600mm
BFS-8	1/4"	6.4mm	1/8"	3.2mm	.035	0.9mm	24"	600mm
BFS-10	5/16"	7.9mm	5/32"	4.0mm	.045	1.1mm	24"	600mm
BFS-12	3/8"	9.5mm	3/16"	4.8mm	.045	1.1mm	15"	375mm
BFS-14	7/16"	11.1mm	7/32"	5.6mm	.055	1.4mm	15"	375mm
BFS-16	1/2"	12.7mm	1/4"	6.4mm	.060	1.5mm	15"	375mm
BFS-18	9/16"	14.3mm	9/32"	7.1mm	.060	1.5mm	15"	375mm
BFS-20	5/8"	15.9mm	5/16"	7.9mm	.060	1.5mm	15"	375mm

TIP:

For professional quality painting of structures, it is recommended that, when possible, construction of the main components be completed and painted assembled. Paint sub-assemblies and other detail parts before attaching to the main structure. Use solvent cement sparingly during final assembly so paint will not run.

STRUCTURAL SHAPES

TRADITIONAL ABS H-COLUMNS

Use for vertical or diagonal members in the construction of most steel structures. Precision Injection Molded in Dark Gray ABS Plastic. Ideal for all outdoor or professional model construction where model life is critical. High impact characteristics provide durability, flexibility and longevity of the model.

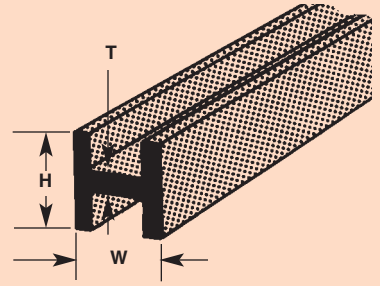

CODE	ACTUAL SIZE							
	'H'		'W'		'T'		LENGTH	
H-2	1/16"	1.6mm	1/16"	1.6mm	.020	0.5mm	10"	250mm
H-3	3/32"	2.4mm	3/32"	2.4mm	.025	0.6mm	15"	375mm
H-4	1/8"	3.2mm	1/8"	3.2mm	.035	0.9mm	15"	375mm
H-6	3/16"	4.8mm	3/16"	4.8mm	.055	1.4mm	24"	600mm
H-8	1/4"	6.4mm	1/4"	6.4mm	.060	1.5mm	15"	• 375mm
H-10	5/16"	7.9mm	5/16"	7.9mm	.065	1.7mm	15"	• 375mm
H-12	3/8"	9.5mm	3/8"	9.5mm	.070	1.8mm	15"	• 375mm
H-14	7/16"	11.1mm	7/16"	11.1mm	.075	1.9mm	15"	• 375mm
H-16	1/2"	12.7mm	1/2"	12.7mm	.085	2.2mm	15"	• 375mm
H-18	9/16"	14.3mm	9/16"	14.3mm	.085	2.2mm	15"	• 375mm
H-20	5/8"	15.9mm	5/8"	15.9mm	.085	2.2mm	15"	• 375mm
H-24	3/4"	19.1mm	3/4"	19.1mm	.090	2.3mm	15"	• 375mm

NOTE:

- These Products are also available at double the shown length for twice the listed price. Just add 'L' to the end of the Product Code. Example: H-12L

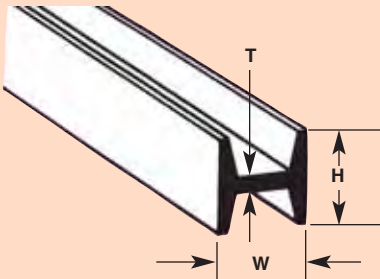

FINELINE STYRENE H-COLUMNS

Use for vertical or horizontal members in the construction of most steel structures. Precision Extruded in White Styrene Plastic. Ideal for museum quality and smaller scale model construction where assembly speed, profile accuracy and cost are the determining factors.

CODE	ACTUAL SIZE							
	'H'		'W'		'T'		LENGTH	
HFS-2	1/16"	1.6mm	1/16"	1.6mm	.020	0.5mm	10"	250mm
HFS-3	3/32"	2.4mm	3/32"	2.4mm	.025	0.6mm	15"	375mm
HFS-4	1/8"	3.2mm	1/8"	3.2mm	.035	0.9mm	15"	375mm
HFS-5	5/32"	4.0mm	5/32"	4.0mm	.030	0.8mm	15"	375mm
HFS-6	3/16"	4.8mm	3/16"	4.8mm	.035	0.9mm	24"	600mm
HFS-8	1/4"	6.4mm	1/4"	6.4mm	.040	1.0mm	15"	375mm
HFS-10	5/16"	7.9mm	5/16"	7.9mm	.045	1.1mm	15"	375mm
HFS-12	3/8"	9.5mm	3/8"	9.5mm	.055	1.4mm	15"	375mm



Photo courtesy of Paul Gesso, Denver, CO

TRADITIONAL ABS CHANNELS

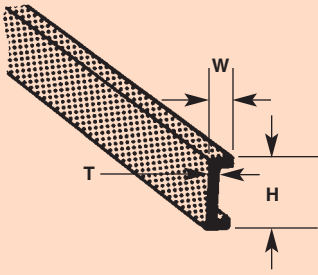

Use for bracing or lightweight vertical support members in the construction of most steel structures. Precision Injection Molded in Dark Gray ABS Plastic. Ideal for all outdoor or professional model construction where model life is critical. High impact characteristics provide durability, flexibility and longevity of the model.

CODE	ACTUAL SIZE						LENGTH	
	'H'		'W'		'T'			
C-2	1/16"	1.6mm	.035	0.9mm	.015	0.4mm	10"	250mm
C-3	3/32"	2.4mm	.040	1.0mm	.020	0.5mm	10"	250mm
C-4	1/8"	3.2mm	.050	1.3mm	.025	0.6mm	15"	375mm
C-6	3/16"	4.8mm	1/16"	1.6mm	.040	1.0mm	15"	375mm
C-8	1/4"	6.4mm	5/64"	2.0mm	.050	1.3mm	24"	600mm
C-10	5/16"	7.9mm	3/32"	2.4mm	.050	1.3mm	24"	600mm
C-12	3/8"	9.5mm	3/32"	2.4mm	.055	1.4mm	15"	• 375mm
C-14	7/16"	11.1mm	1/8"	3.2mm	.060	1.5mm	15"	• 375mm
C-16	1/2"	12.7mm	1/8"	3.2mm	.065	1.7mm	15"	• 375mm
C-18	9/16"	14.3mm	1/8"	3.2mm	.065	1.7mm	15"	• 375mm
C-20	5/8"	15.9mm	3/16"	4.8mm	.075	1.9mm	15"	• 375mm
C-24	3/4"	19.0mm	3/16"	4.8mm	.075	1.9mm	15"	• 375mm

NOTE:

- These Products are also available at double the shown length for twice the listed price. Just add 'L' to the end of the Product Code. Example: C-16L

FINELINE STYRENE CHANNELS

Use for bracing or lightweight vertical support members in the construction of most steel structures. Precision Extruded in White Styrene Plastic. Ideal for museum quality and smaller scale model construction where assembly speed, profile accuracy and cost are the determining factors.

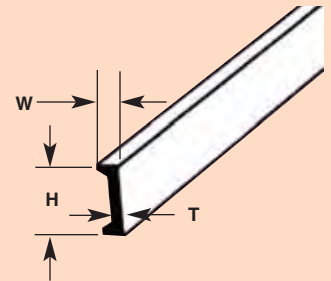

CODE	ACTUAL SIZE						LENGTH	
	'H'		'W'		'T'			
CFS-2	1/16"	1.6mm	.035	0.9mm	.015	0.4mm	10"	250mm
CFS-3	3/32"	2.4mm	.040	1.0mm	.020	0.5mm	10"	250mm
CFS-4	1/8"	3.2mm	.050	1.3mm	.025	0.6mm	15"	375mm
CFS-5	5/32"	4.0mm	.055	1.4mm	.030	0.8mm	15"	375mm
CFS-6	3/16"	4.8mm	1/16"	1.6mm	.035	0.9mm	15"	375mm
CFS-8	1/4"	6.4mm	5/64"	2.0mm	.035	0.9mm	24"	600mm
CFS-10	5/16"	7.9mm	3/32"	2.4mm	.045	1.1mm	24"	600mm



Photo courtesy of Alan Graziano, South Plainfield, NJ

STRUCTURAL SHAPES

ABS LARGE STRUCTURAL ASSEMBLIES

A quick and simple method for assembly of **LARGE** structural I-Beams and H-Columns using the components below. Flange includes a 1/8" (3.2mm) wide by 1/16" (1.6mm) deep slot providing a snug fit for the Web. For best results, assemble parts dry before applying cement. Using a sloping V-block jig will help ensure 90° angles and allow rapid and complete solvent bonding by capillary action.

When determining the correct components, be sure to subtract 1/8" (3.2mm) from the required Web dimension. Example: 3/4" (19.1mm) W x 2" (50.8mm) H Finished Size = two SAF-24 plus one SAW-60.

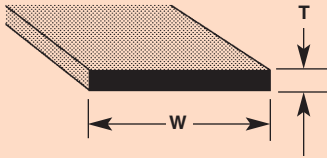
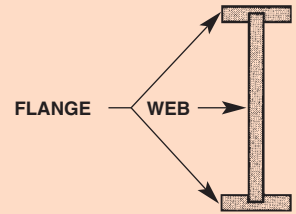

ABS STRUCTURAL WEBS

Use for custom fabrication of structural I-Beams and H-Columns. Precision Extruded in Dark Gray ABS Plastic. Ideal for all large scale and outdoor model construction where strength and size is critical. High impact characteristics provide durability, flexibility and longevity of the model.

CODE	ACTUAL SIZE			
	'W'		'T'	
SAW-24L	3/4"	19.1mm	1/8"	3.2mm
SAW-28L	7/8"	22.2mm	1/8"	3.2mm
SAW-32L	1"	25.4mm	1/8"	3.2mm
SAW-36L	1-1/8"	28.6mm	1/8"	3.2mm
SAW-40L	1-1/4"	31.8mm	1/8"	3.2mm
SAW-44L	1-3/8"	34.9mm	1/8"	3.2mm
SAW-48L	1-1/2"	38.1mm	1/8"	3.2mm
SAW-52L	1-5/8"	41.3mm	1/8"	3.2mm
SAW-56L	1-3/4"	44.4mm	1/8"	3.2mm
SAW-60L	1-7/8"	47.6mm	1/8"	3.2mm
SAW-64L	2"	50.8mm	1/8"	3.2mm

NOTE: 30" (750mm) Length.

ABS STRUCTURAL FLANGES

Use for custom fabrication of structural I-Beams and H-Columns. Precision Injection Molded in Dark Gray ABS Plastic. Ideal for all large scale and outdoor model construction where strength and size is critical. High impact characteristics provide durability, flexibility and longevity of the model. Slot is 1/16" (1.6mm) deep.

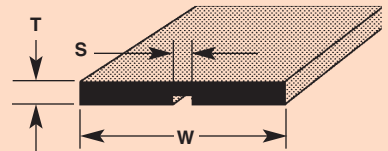

CODE	ACTUAL SIZE					
	'W'		'T'		'S'	
SAF-12L	3/8"	9.5mm	1/8"	3.2mm	1/8"	3.2mm
SAF-14L	7/16"	11.1mm	1/8"	3.2mm	1/8"	3.2mm
SAF-16L	1/2"	12.7mm	1/8"	3.2mm	1/8"	3.2mm
SAF-18L	9/16"	14.3mm	1/8"	3.2mm	1/8"	3.2mm
SAF-20L	5/8"	15.9mm	1/8"	3.2mm	1/8"	3.2mm
SAF-22L	11/16"	17.5mm	1/8"	3.2mm	1/8"	3.2mm
SAF-24L	3/4"	19.1mm	1/8"	3.2mm	1/8"	3.2mm
SAF-28L	7/8"	22.2mm	1/8"	3.2mm	1/8"	3.2mm
SAF-30L	15/16"	23.8mm	1/8"	3.2mm	1/8"	3.2mm
SAF-32L	1"	25.4mm	1/8"	3.2mm	1/8"	3.2mm
SAF-36L	1-1/8"	28.6mm	1/8"	3.2mm	1/8"	3.2mm
SAF-40L	1-1/4"	31.8mm	1/8"	3.2mm	1/8"	3.2mm

NOTE: 30" (750mm) Length.

OPEN WEB TRUSS - WARREN STYLE 2

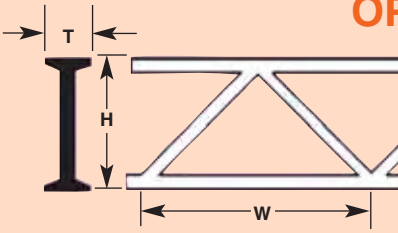

Use for roof trusses, bridges, conveyors, space frames and other steel structures. Precision Injection Molded in Dark Gray ABS Plastic. Ideal for all outdoor or professional model construction where model life is critical. High impact characteristics provide durability, flexibility and longevity of the model.

CODE	ACTUAL SIZE							
	'H'		'W'		'T'		LENGTH	
OWTA-4	1/8"	3.2mm	3/16"	4.8mm	1/16"	1.6mm	6"	150mm
OWTA-6	3/16"	4.8mm	1/4"	6.4mm	3/32"	2.4mm	6"	150mm
OWTA-8	1/4"	6.4mm	3/8"	9.5mm	1/8"	3.2mm	6"	150mm
OWTA-12	3/8"	9.5mm	5/8"	15.9mm	11/64"	4.4mm	6"	150mm
OWTA-16	1/2"	12.7mm	27/32"	21.4mm	3/16"	4.8mm	12"	300mm
OWTA-20	5/8"	15.9mm	1-3/32"	27.8mm	1/4"	6.4mm	12"	300mm
OWTA-24	3/4"	19.1mm	1-21/64"	33.7mm	1/4"	6.4mm	12"	300mm
OWTA-32	1"	25.4mm	1-27/32"	46.8mm	5/16"	7.9mm	12"	300mm

Same as above, except Precision Injection Molded in White Styrene Plastic. Ideal when assembly speed and cost are the determining factor.

CODE	ACTUAL SIZE							
	'H'		'W'		'T'		LENGTH	
OWTS-4	1/8"	3.2mm	3/16"	4.8mm	1/16"	1.6mm	6"	150mm
OWTS-6	3/16"	4.8mm	1/4"	6.4mm	3/32"	2.4mm	6"	150mm
OWTS-8	1/4"	6.4mm	3/8"	9.5mm	1/8"	3.2mm	6"	150mm
OWTS-12	3/8"	9.5mm	5/8"	15.9mm	11/64"	4.4mm	6"	150mm
OWTS-16	1/2"	12.7mm	27/32"	21.4mm	3/16"	4.8mm	12"	300mm
OWTS-20	5/8"	15.9mm	1-3/32"	27.8mm	1/4"	6.4mm	12"	300mm
OWTS-24	3/4"	19.1mm	1-21/64"	33.7mm	1/4"	6.4mm	12"	300mm
OWTS-32	1"	25.4mm	1-27/32"	46.8mm	5/16"	7.9mm	12"	300mm

OPEN WEB TRUSS - WARREN STYLE 1

Excellent for towers and booms. Also good for roof trusses, bridges, conveyors, and space frames. Precision Injection Molded in Dark Gray ABS Plastic. Ideal for all outdoor or professional model construction where model life is critical. High impact characteristics provide durability, flexibility and longevity of the model.

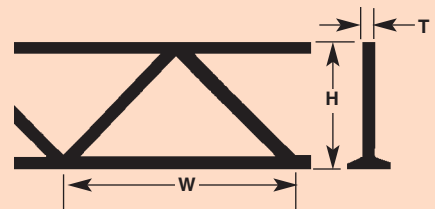

CODE	ACTUAL SIZE							
	'H'		'W'		'T'		LENGTH	
OTS-4	1/8"	3.2mm	3/16"	4.8mm	.015	0.4mm	3-1/4"	80mm
OTS-6	13/64"	5.2mm	11/32"	8.7mm	3/32"	2.4mm	3-1/2"	90mm
OTS-8	9/32"	7.1mm	31/64"	12.3mm	7/64"	2.8mm	5"	125mm
OTS-12	13/32"	10.3mm	11/16"	17.5mm	9/64"	3.6mm	7"	175mm
OTS-16	1/2"	12.7mm	29/32"	23.0mm	11/64"	4.4mm	9"	225mm
OTS-20	5/8"	15.9mm	1-3/32"	27.8mm	11/64"	4.4mm	11"	275mm
OTS-24	3/4"	19.1mm	1-23/64"	34.5mm	11/64"	4.4mm	11"	275mm
OTS-32	1"	25.4mm	1-13/16"	46.0mm	3/16"	4.8mm	11"	275mm

TIP:



Tee flange on one edge only allows easy registered assembly for triangular and square sections as pictured at left. Protruding side of flange may be removed if desired.

STRUCTURAL SHAPES

OPEN WEB TRUSS - PRATT STYLE

Use for roof trusses, bridges, conveyors, space frames and other steel structures. Precision Injection Molded in Silver Styrene Plastic. Manufactured with detail on one side only. If structure will be visible from both sides, it may be desirable to cement two pieces back-to-back for realism.

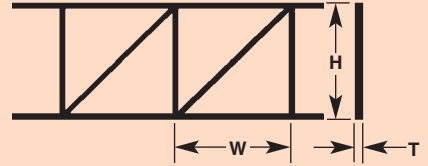

CODE	ACTUAL SIZE							
	'H'		'W'		'T'		LENGTH	
OWT-101	1/4"	6.4mm	3/16"	4.8mm	.027	0.7mm	4"	100mm
OWT-102	5/16"	7.9mm	1/4"	6.4mm	.040	1.0mm	4"	100mm
OWT-103	7/16"	11.1mm	3/8"	9.5mm	.045	1.1mm	7"	175mm
OWT-104	43/64"	17.1mm	9/16"	14.3mm	.050	1.3mm	7"	175mm
OWT-105	27/32"	21.4mm	3/4"	19.1mm	.050	1.3mm	8"	200mm
OWT-106	1-1/4"	31.8mm	1-1/8"	28.6mm	.065	1.7mm	7"	175mm
OWT-107	1-5/8"	41.3mm	1-5/8"	41.3mm	.065	1.7mm	8"	200mm

OPEN WEB TRUSS - CELLFORM STYLE

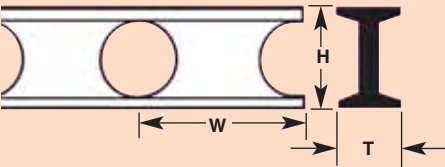

Use for roof trusses, space frames and other modern and/or futuristic steel structures. Precision Injection Molded in Styrene Plastic. Manufactured with a special tongue and groove connection feature to quickly and accurately attain the desired length.

CODE	ACTUAL SIZE							
	'H'		'W'		'T'		LENGTH	
OWT-201	1/8"	3.2mm	5/32"	4.0mm	1/16"	1.6mm	4-1/16"	100mm
OWT-202	7/32"	5.6mm	1/4"	6.4mm	3/32"	2.4mm	4-1/16"	100mm
OWT-203	5/16"	7.9mm	13/32"	10.3mm	7/64"	2.8mm	4-1/16"	100mm
OWT-204	13/32"	10.3mm	9/16"	14.3mm	1/8"	3.2mm	4-3/8"	110mm



Photo courtesy of John Wilkes, Winterhaven, FL ; photo by Bill Schaumburg, Railroad Model Craftsman

HAND RAILS

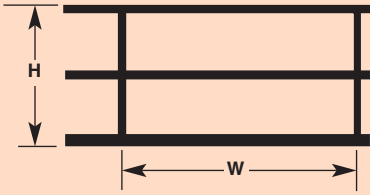

Use for hand rails on platforms, walkways, balconies and any other elevated structures with public access. Precision Injection Molded in Gray ABS or White Styrene Plastic (as noted). Ideal for all outdoor or professional model construction where model life is critical. High impact characteristics provide durability, flexibility and longevity of the model.

CODE	SCALE	ACTUAL SIZE				MATERIAL	
		'H'		'W'			LENGTH
HR-2	N 1:200	17/64"	6.7mm	7/16"	11.1mm	3-5/8" 90mm	ABS
HR-4	HO 1:100	7/16"	11.1mm	3/4"	19.1mm	6" 150mm	ABS
HR-8	O 1:48	29/32"	23.0mm	1-1/2"	38.1mm	24" 600mm	ABS
HR-12	1:32	1-11/32"	34.1mm	2-1/4"	57.2mm	24" 600mm	ABS
HR-16	G 1:24	1-3/4"	44.5mm	3"	76.2mm	24" 600mm	ABS
HR-24	1:16	2-43/64"	67.9mm	4-1/2"	114.3mm	24" 600mm	ABS
HRS-2	N 1:200	17/64"	6.7mm	7/16"	11.1mm	3-5/8" 90mm	Styrene
HRS-4	HO 1:100	7/16"	11.1mm	3/4"	19.1mm	6" 150mm	Styrene
HRS-8	O 1:48	29/32"	23.0mm	1-1/2"	38.1mm	24" 600mm	Styrene
HRS-12	1:32	1-11/32"	34.1mm	2-1/4"	57.2mm	24" 600mm	Styrene
HRS-16	G 1:24	1-3/4"	44.5mm	3"	76.2mm	24" 600mm	Styrene

STAIR RAILS

Use for hand rails on stairways. Precision Injection Molded in Gray ABS or White Styrene Plastic (as noted). Ideal for all outdoor or professional model construction where model life is critical. High impact characteristics provide durability, flexibility and longevity of the model.

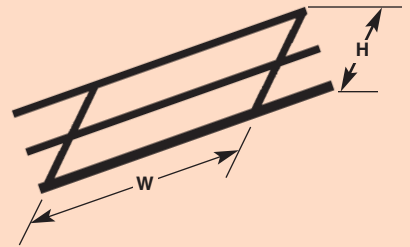

CODE	SCALE	ACTUAL SIZE				MATERIAL	
		'H'		'W'			LENGTH
SR-2	N 1:200	1/4"	6.4mm	7/16"	11.1mm	3-5/8" 90mm	ABS
SR-4	HO 1:100	27/64"	10.7mm	3/4"	19.1mm	6" 150mm	ABS
SR-8	O 1:48	7/8"	22.2mm	1-1/2"	38.1mm	24" 600mm	ABS
SR-12	1:32	1-5/16"	33.3mm	2-1/4"	57.2mm	24" 600mm	ABS
SR-16	G 1:24	1-3/4"	44.5mm	3"	76.2mm	24" 600mm	ABS
SR-24	1:16	2-21/32"	67.5mm	4-1/2"	114.3mm	24" 600mm	ABS
SRS-2	N 1:200	1/4"	6.4mm	7/16"	11.1mm	3-5/8" 90mm	Styrene
SRS-4	HO 1:100	27/64"	10.7mm	3/4"	19.1mm	6" 150mm	Styrene
SRS-8	O 1:48	7/8"	22.2mm	1-1/2"	38.1mm	24" 600mm	Styrene
SRS-12	1:32	1-5/16"	33.3mm	2-1/4"	57.2mm	24" 600mm	Styrene
SRS-16	G 1:24	1-3/4"	44.5mm	3"	76.2mm	24" 600mm	Styrene

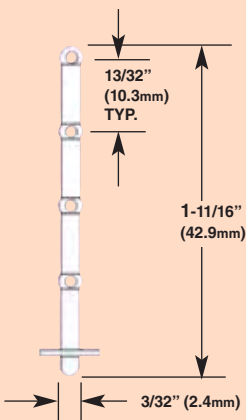

1:16 HANDRAIL STANCHIONS

Independent hand rail stanchions for circular and non-standard or angled applications. Trimming one or two horizontal junctions allows use in other scales. Designed for use with our MIW-1 or TB-1. 3/32" (2.4mm) O.D. Precision Injection Molded in White ABS Plastic. Sold in bags of 10 pcs. ONLY.

CODE: HRS-24

STRUCTURAL SHAPES

STAIRWAYS

Use for open stairways commonly found in industrial complexes, high-rise fire stairs, parking structures, tanks, platforms and other unfinished or open structures. Precision Injection Molded in Gray ABS or White Styrene Plastic (as noted). Ideal for all outdoor or professional model construction where model life is critical.

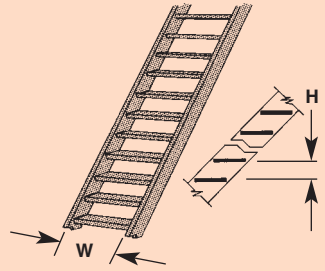

CODE	SCALE	ACTUAL SIZE						SCALE		MATERIAL
		'H'		'W'		LENGTH		WIDTH		
STA-2	N 1:200	3/32"	2.4mm	7/32"	5.6mm	3"	75mm	2'-6"	760mm	ABS
STA-4	HO 1:100	9/64"	3.6mm	25/64"	9.9mm	5"	125mm	2'-6"	760mm	ABS
STA-6	O 1:48	17/64"	6.7mm	3/4"	19.1mm	12"	300mm	2'-6"	760mm	ABS
STA-8	O 1:48	17/64"	6.7mm	7/8"	22.2mm	12"	300mm	3'-0"	910mm	ABS
STA-12	1:32	13/32"	10.3mm	1-1/8"	28.6mm	12"	300mm	2'-6"	760mm	ABS
STA-14	1:32	13/32"	10.3mm	1-5/16"	33.3mm	12"	300mm	3'-0"	910mm	ABS
STA-16	G 1:24	17/32"	13.5mm	1-7/16"	36.5mm	12"	300mm	2'-6"	760mm	ABS
STA-18	G 1:24	17/32"	13.5mm	1-11/16"	42.9mm	12"	300mm	3'-0"	910mm	ABS
STA-20	1:16	13/16"	20.6mm	2-3/32"	53.2mm	12"	300mm	2'-6"	760mm	ABS
STA-22	1:16	13/16"	20.6mm	2-15/32"	62.7mm	12"	300mm	3'-0"	910mm	ABS
STAS-2	N 1:200	3/32"	2.4mm	7/32"	5.6mm	3"	75mm	2'-6"	760mm	Styrene
STAS-4	HO 1:100	9/64"	3.6mm	25/64"	9.9mm	5"	125mm	2'-6"	760mm	Styrene
STAS-6	O 1:48	17/64"	6.7mm	3/4"	19.1mm	12"	300mm	2'-6"	760mm	Styrene
STAS-8	O 1:48	17/64"	6.7mm	7/8"	22.2mm	12"	300mm	3'-0"	910mm	Styrene
STAS-16	G 1:24	17/32"	13.5mm	1-7/16"	36.5mm	12"	300mm	2'-6"	760mm	Styrene
STAS-18	G 1:24	17/32"	13.5mm	1-11/16"	42.9mm	12"	300mm	3'-0"	910mm	Styrene

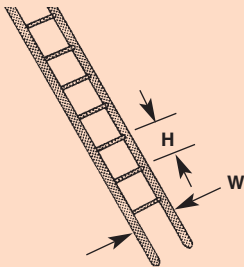

LADDERS

Use as straight ladders commonly found in numerous industrial, commercial, and residential applications. Note, in most industrial applications using a fixed ladder, a cage is also desirable. Precision Injection Molded in Gray ABS or White Styrene Plastic (as noted). Ideal for all outdoor or professional model construction where model life is critical.

CODE	SCALE	ACTUAL SIZE						MATERIAL
		'H'		'W'		LENGTH		
KL-2	N 1:200	5/64"	2.0mm	5/32"	4.0mm	3"	75mm	ABS
KL-4	HO 1:100	1/8"	3.2mm	1/4"	6.4mm	5"	125mm	ABS
KL-8	O 1:48	1/4"	6.4mm	13/32"	10.3mm	15"	375mm	ABS
KL-12	1:32	3/8"	9.5mm	39/64"	15.5mm	15"	375mm	ABS
KL-16	G 1:24	1/2"	12.7mm	3/4"	19.1mm	15"	375mm	ABS
KL-24	1:16	3/4"	19.1mm	1-3/32"	27.8mm	15"	375mm	ABS
LS-2	N 1:200	5/64"	2.0mm	5/32"	4.0mm	3"	75mm	Styrene
LS-4	HO 1:100	1/8"	3.2mm	1/4"	6.4mm	5"	125mm	Styrene
LS-8	O 1:48	1/4"	6.4mm	13/32"	10.3mm	15"	375mm	Styrene
LS-12	1:32	3/8"	9.5mm	39/64"	15.5mm	15"	375mm	Styrene
LS-16	G 1:24	1/2"	12.7mm	3/4"	19.1mm	15"	375mm	Styrene
LS-24	1:16	3/4"	19.1mm	1-3/32"	27.8mm	15"	375mm	Styrene

TIP:

ABS hand rails and stair rails may be curved to fit circular applications by softening them in warm water or heating with a hair dryer. Stairs may be modified to fit the circumference of a tank or other curved surface by cutting off the stair stringer from the side to be cemented. Tape the stair in place. Attach each stair step separately.

STRUCTURAL SHAPES

CUSTOM STAIRCASES

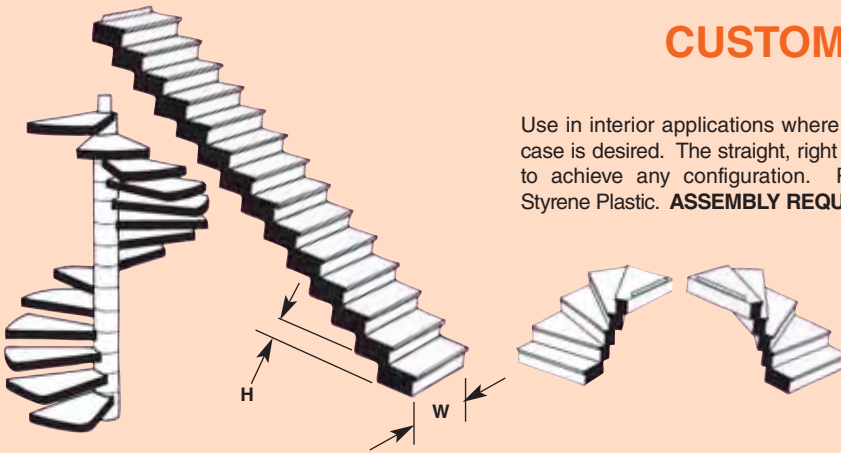

Use in interior applications where a closed casing or spiral stair case is desired. The straight, right and left sets may be combined to achieve any configuration. Precision Injection Molded in Styrene Plastic. **ASSEMBLY REQUIRED.**

CODE	SCALE	ACTUAL SIZE						STYLE
		'H'		'W'		LENGTH		
STAA-24	G 1:24	19/64"	7.5mm	1-9/16"	39.7mm	7-1/2"	190mm	Straight
STAA-48	O 1:48	9/64"	3.6mm	57/64"	22.6mm	3-3/4"	95mm	Straight
STAL-24	G 1:24	19/64"	7.5mm	1-9/16"	39.7mm	2-3/8"	60mm	Left Turn
STAL-48	O 1:48	9/64"	3.6mm	57/64"	22.6mm	1"	25mm	Left Turn
STAR-24	G 1:24	19/64"	7.5mm	1-9/16"	39.7mm	2-3/8"	60mm	Right Turn
STAR-48	O 1:48	9/64"	3.6mm	57/64"	22.6mm	1"	25mm	Right Turn
STAS-24	G 1:24	19/64"	7.5mm	1-35/64"	39.3mm	4-5/32"	100mm	Spiral
STAS-48	O 1:48	1/8"	3.2mm	63/64"	25.0mm	1-7/8"	50mm	Spiral
STAS-100	HO 1:100	5/32"	4.0mm	7/16"	11.1mm	2-5/16"	58mm	Spiral
STAS-102	HO 1:100	5/64"	2.0mm	13/32"	10.3mm	2-1/4"	57mm	Spiral
STAS-200	N 1:200	5/64"	2.0mm	7/32"	5.6mm	13/16"	20mm	Spiral
STAS-202	N 1:200	3/64"	1.2mm	7/32"	5.6mm	35/64"	14mm	Spiral

STEPS & LOUVRES

Use for steps found in front of commercial or civic buildings where wide or dramatic entrances are common. Two different grades (slopes), 17° and 34°, allow for variety and realism. May also be used for window louvres in larger scale applications. Precision Injection Molded or Vacuum Formed in White Styrene Plastic.

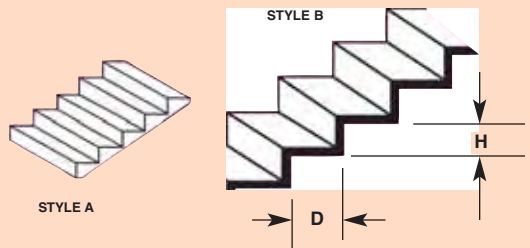

CODE	SCALE	ACTUAL SIZE						STEP GRADE	STYLE		
		'H'		'D'		LENGTH					
STEP-1	1:400	.020	0.5mm	.030	0.8mm	1"	25mm	2-1/2"	70mm	34°	A
STEP-101	1:400	.020	0.5mm	.050	1.3mm	2-1/16"	52mm	3-7/8"	100mm	17°	A
STEP-2	N 1:200	.040	1.0mm	.060	1.5mm	2-1/8"	54mm	3-7/8"	100mm	34°	A
STEP-201	N 1:200	.040	1.0mm	.130	3.3mm	2-1/8"	54mm	3-7/8"	100mm	17°	A
STEP-4	HO 1:100	1/16"	1.6mm	.100	2.5mm	2-1/8"	54mm	3-7/8"	100mm	34°	A
STEP-401	HO 1:100	1/16"	1.6mm	1/4"	6.4mm	2-1/8"	54mm	3-7/8"	100mm	17°	A
STEP-8	O 1:48	.100	2.5mm	.200	5.1mm	12"	300mm	7"	175mm	34°	B
STEP-801	O 1:48	1/8"	3.2mm	1/2"	12.7mm	2-1/8"	54mm	3-7/8"	100mm	17°	A
STEP-12	#1 1:32	.200	5.1mm	.350	8.9mm	12"	300mm	7"	175mm	34°	B

TIP:

To avoid gluing your model to your work surface, especially when working with a fast acting solvent cement like Bondene, we recommend you do all cementing on a sheet of polypropylene. Even better, purchase a few serving trays (cafeteria style) and cut the polypropylene sheet to snugly fit inside. This way, the sides will capture any spilled solvent cement before it spoils furniture, and you can use different trays for different in-progress projects.

STRUCTURAL SHAPES

SAFETY CAGE AND LADDER SET

Use on towers, tanks, buildings and other tall structures where a ladder is perpendicular (or 90°) to the ground. Precision Injection Molded in Gray ABS or White Styrene. Ideal for all outdoor or professional model construction where model life is critical. High impact characteristics provide durability, flexibility and longevity of the model.



CODE	SCALE	ACTUAL SIZE				FITS	
		DIAMETER		LENGTH		LADDER	MATERIAL
CL-4	HO 1:100	27/64"	10.7mm	4-7/8"	125mm	KL-4	ABS
CL-8	O 1:48	23/32"	18.3mm	12"	300mm	KL-8	ABS
CL-12	1:32	1"	25.4mm	12"	300mm	KL-12	ABS
CL-16	G 1:24	1-19/64"	32.9mm	12"	300mm	KL-16	ABS
CLS-4	HO 1:100	27/64"	10.7mm	4-7/8"	125mm	LS-4	Styrene
CLS-8	O 1:48	23/32"	18.3mm	12"	300mm	LS-8	Styrene
CLS-12	1:32	1"	25.4mm	12"	300mm	LS-12	Styrene
CLS-16	G 1:24	1-19/64"	32.9mm	12"	300mm	LS-16	Styrene

1:200 BRASS STAIR, LADDER & RAILING SET

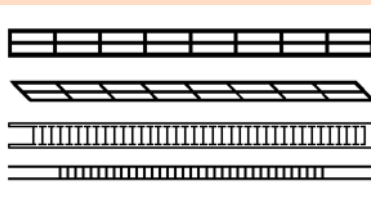

While these fine, Brass etchings may be used for many applications, particularly where bending or a radius is involved, they are ideal for modifying metal rolling stock. Each item is duplicated to industry standard dimensions and design. Actual length 3-3/4" (95mm).

CODE: SLR-200

BALCONY RAILINGS

Use for balcony railings or bannisters in residential, commercial or civic buildings where fancy handrailing is desired. Precision Injection Molded in Brown Styrene Plastic.

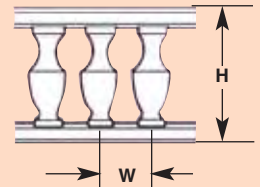

CODE	SCALE	ACTUAL SIZE				
		'H'		'W'		LENGTH
BALC-48	O 1:48	23/32"	18.3mm	9/32"	7.1mm	6-1/2" 165mm
BALC-100	HO 1:100	25/64"	9.9mm	9/64"	3.6mm	6-1/2" 165mm
BALC-200	N 1:200	7/32"	5.6mm	3/32"	2.4mm	6-1/2" 165mm



VICTORIAN RAILING TRIM

Use for Victorian Trim or fancy balcony railings. Precision Injection Molded in white Styrene Plastic.

CODE	ACTUAL SIZE			
	HEIGHT		LENGTH	
TRIM-8	1/4"	6.3mm	3-1/2"	88.9mm



STRUCTURAL SHAPES

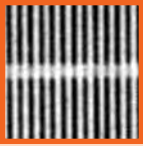

STYLE A



STYLE B

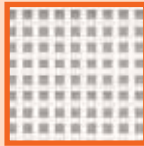

STYLE C



STYLE D



STYLE E

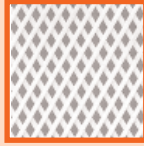

STYLE F

LATTICE/TRELLIS PANELS

Use for latticework or trelliswork screens or ornamental structures. LAT- 70 has notches to permit modification using Styrene Strips. Precision Injection Molded in Styrene (10,30, 60, 70, 80 & 90) or Polyethylene Plastic (20, 40 & 50). Ideal for architectural or dollhouse miniature models.

CODE	ACTUAL SIZE								STYLE
	'H'		'W'		'T'		PATTERN		
LAT-10	2-1/8"	54.0mm	15/16"	23.8mm	1/32"	0.8mm	.039	1.0mm	A
LAT-20	4"	101.6mm	1-1/4"	31.8mm	1/16"	1.6mm	.040	1.0mm	B
LAT-30	2"	50.8mm	3-5/8"	92.0mm	3/32"	2.4mm	3/32"	2.4mm	C
LAT-40	4-1/8"	104.8mm	2"	50.8mm	3/32"	2.4mm	.040	1.0mm	D
LAT-50	3-15/16"	100.0mm	2-7/16"	61.9mm	5/64"	2.0mm	.075	1.9mm	B
LAT-60	1-7/8"	47.6mm	1-7/16"	36.5mm	3/32"	2.4mm	15/64"	6.0mm	B
LAT-70	5-7/8"	149.2mm	2-7/8"	73.0mm	1/8"	3.2mm	5/8"	15.9mm	B
LAT-80	2-1/2"	63.5mm	4-1/2"	114.3mm	3/16"	4.8mm	3/8"	9.5mm	E
LAT-90	2"	50.8mm	3-5/8"	92.0mm	3/32"	2.4mm	1/8"	3.2mm	F

RAILINGS/TRELLIS/FENCING

Use for hand rails, stair rails, roof trusses, grating and other steel structures. Precision Injection Molded in Styrene Plastic. May also be used for trellises, fencing, window bars, etc.

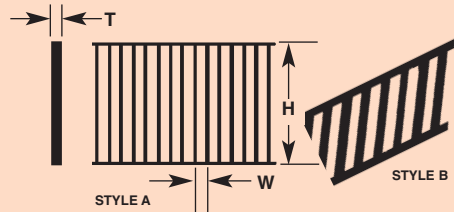

CODE	ACTUAL SIZE								STYLE
	'H'		'W'		'T'		LENGTH		
RR-2	1/4"	6.4mm	3/32"	2.4mm	.040	1.0mm	7"	175mm	A
RR-3	9/32"	7.1mm	3/32"	2.4mm	.030	0.8mm	6-5/8"	165mm	B
RR-4	13/32"	10.3mm	3/32"	2.4mm	.050	1.3mm	6-7/8"	175mm	A
RR-6	19/32"	15.1mm	3/32"	2.4mm	.055	1.4mm	6-7/8"	175mm	A
RR-7	5/8"	15.9mm	1/8"	3.2mm	.045	1.1mm	7"	175mm	B
RR-8	25/32"	19.8mm	1/8"	3.2mm	.055	1.4mm	7"	175mm	A
RR-10	1"	25.4mm	1/8"	3.2mm	.055	1.4mm	5"	127mm	A
RR-12	1-7/32"	31.0mm	3/16"	4.8mm	.055	1.4mm	6-1/2"	165mm	A
RR-16	1-39/64"	40.9mm	3/16"	4.8mm	.055	1.4mm	6-1/4"	160mm	A
RR-20	2-11/32"	59.5mm	1/4"	6.4mm	.085	2.2mm	5"	127mm	A



DECK RAILING WITH STAIRS

Use for decking hand rails with stairs included. For matching railing see code: RR-10.

CODE	ACTUAL SIZE			
	RAIL HEIGHT		STAIR WIDTH	
SRST-8	1"	25.4mm	7/8"	22.2mm

STRUCTURAL SHAPES

FENCES & RAILINGS

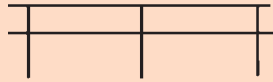

STYLE A

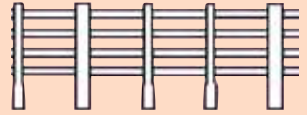

STYLE B



STYLE C

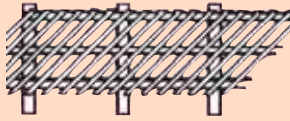

STYLE D

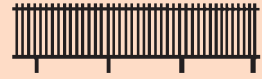

STYLE E

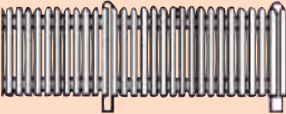

STYLE F

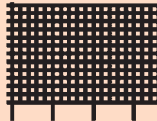

STYLE G

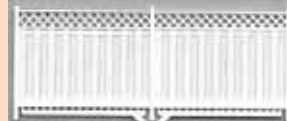

STYLE H



STYLE I



STYLE J



STYLE K

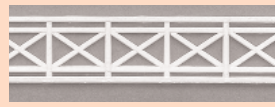

STYLE L



STYLE GATE



STYLE M



STYLE N

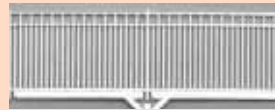

STYLE O

Use for fences commonly found in agricultural, residential, industrial, commercial and many other settings. Some styles may also be used for railings or trellises. Precision Injection Molded in White Styrene Plastic or acid etched in Brass (as noted). Ideal for all model construction.

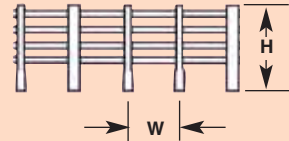

For Custom Chain Link Fence, Code FEN-4, see page 111.

CODE	SCALE	ACTUAL SIZE				STYLE	MATERIAL		
		'H'		'W'				LENGTH	
FEN-12	N 1:200	1/4"	6.4mm	25/64"	9.9mm	9-1/2"	240mm	A Ranch Post	Brass
FEN-14	HO 1:100	11/32"	8.7mm	1/4"	6.4mm	20"	500mm	B Ranch Post	Styrene
FEN-15	HO 1:100	17/32"	13.5mm	9/16"	14.3mm	9-1/2"	240mm	C Ranch Post	Brass
FEN-18	O 1:48	1-11/64"	29.8mm	57/64"	22.6mm	30"	750mm	B Ranch Post	Styrene
FEN-24	HO 1:100	11/32"	8.7mm	11/32"	8.7mm	20"	500mm	D Diag. Picket	Styrene
FEN-28	O 1:48	45/64"	17.9mm	45/64"	17.9mm	30"	750mm	D Diag. Picket	Styrene
FEN-31	1:500	11/64"	4.4mm	1/4"	6.4mm	75"	1900mm	E Picket	Brass
FEN-32	N 1:200	15/64"	6.0mm	15/64"	6.0mm	52"	1300mm	E Picket	Brass
FEN-34	HO 1:100	23/64"	9.1mm	41/64"	16.3mm	20"	500mm	F Picket	Styrene
FEN-38	O 1:48	43/64"	17.1mm	1-1/4"	31.8mm	30"	750mm	F Picket	Styrene
FEN-42	N 1:200	1/2"	12.7mm	3/16"	4.8mm	26"	650mm	G Chain Link	Brass
NEW FEN-44	HO 1:100	1"	25.4mm	1/8"	3.2mm	8"	203mm	H Vert. Lattice	Styrene
NEW FEN-48	O 1:48	1-3/4"	44.5mm	1/4"	6.4mm	8"	203mm	H Vert. Lattice	Styrene
FEN-52	N 1:200	1/4"	6.4mm	1/16"	1.6mm	26"	650mm	I Picket	Styrene
FEN-54	HO 1:100	29/64"	11.5mm	3/32"	2.4mm	28"	700mm	I Picket	Styrene
FEN-58	O 1:48	59/64"	23.4mm	13/64"	5.2mm	28"	700mm	I Picket	Styrene
FEN-64	HO 1:100	5/16"	7.9mm	1/16"	1.6mm	20"	500mm	I Picket	Styrene
FEN-68	O 1:48	5/8"	15.9mm	3/32"	2.4mm	20"	500mm	I Picket	Styrene
NEW FEN-74	HO 1:100	5/8"	15.9mm	1/16"	1.6mm	8"	203mm	J Vert. Knob	Styrene
NEW FEN-78	O 1:48	1-3/8"	34.9mm	1/8"	3.2mm	8"	203mm	K Vert. Circle	Styrene
NEW FEN-84	HO 1:100	1/2"	12.7mm	3/8"	9.5mm	8"	203mm	L Cross Bar	Styrene
NEW FEN-88	O 1:48	1-1/16"	27.0mm	1/8"	3.2mm	6-1/2"	165mm	M Low Bar	Styrene
NEW FEN-94	HO 1:100	5/8"	15.9mm	1/16"	1.6mm	8"	203mm	N Picket	Styrene
NEW FEN-98	O 1:48	1-1/2"	38.1mm	1/8"	3.2mm	10"	254mm	M High Bar	Styrene
NEW GATE-98	O 1:48	2"	50.8mm	1-3/4"	44.5mm	(one piece)		Gate High Bar	Styrene
NEW FEN-108	O 1:48	1-1/4"	31.8mm	1/8"	3.2mm	8"	203mm	N Picket	Styrene
NEW FEN-118	O 1:48	1-3/8"	34.9mm	1/16"	1.6mm	8"	203mm	O Square Trim	Styrene

STRUCTURAL FITTINGS

GEORGIAN COLUMNS

Use for pillars in georgian architecture or as porch or balcony supports. May also be used for plant stands or table legs in dollhouse models. COL-100 & COL-48 are cast in White Metal, while COL-24 is cast in Beige Urethane Plastic.

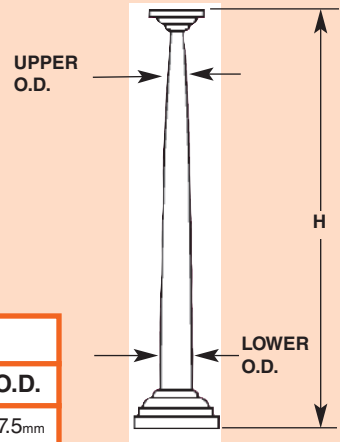

CODE	SCALE	ACTUAL SIZE					
		'H'		UPPER O.D.		LOWER O.D.	
COL-24	G 1:24	8-3/8"	212.7mm	3/8"	9.5mm	11/16"	17.5mm
COL-48	O 1:48	3-13/16"	96.8mm	1/8"	3.2mm	3/8"	9.5mm
COL-100	HO 1:100	1-31/32"	50.0mm	3/32"	2.4mm	3/16"	4.8mm

ABS COLUMN BASE MOUNTS / COLUMN BLOCKS



Use to quickly and effectively mount vertical columns (codes H-4 through H-24) to your model base. Precision Injection Molded in Dark Gray ABS Plastic.

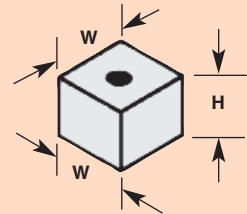

Use to quickly and effectively mount vertical square tubing (codes ST-12 through ST-24) to your model base. Also used for concrete blocks, lamp bases, etc. Precision Injection Molded in Light Gray ABS Plastic.

CODE	TO FIT COLUMN
BM-4	4
BM-6	6
BM-8	8
BM-10	10
BM-12	12 & 14
BM-16	16 & 18
BM-20	20 & 24

CODE	ACTUAL SIZE				TO FIT TUBE
	'H'		'W'		
CB-12	3/8"	9.5mm	9/32"	7.1mm	12
CB-14	3/8"	9.5mm	5/16"	7.9mm	14
CB-16	3/8"	9.5mm	3/8"	9.5mm	16
CB-18	1/2"	12.7mm	7/16"	11.1mm	18
CB-20	1/2"	12.7mm	1/2"	12.7mm	20
CB-24	5/8"	15.9mm	5/8"	15.9mm	24

SUPPORT TRIANGLE GUSSETS

Use to quickly and effectively mount horizontal pieces off of vertical columns, tanks or other structures. Precision Injection Molded in Clear Acrylic Plastic.

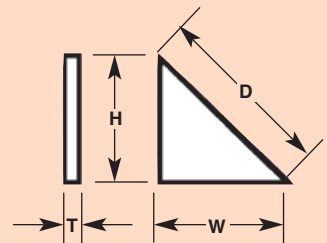

CODE	ACTUAL SIZE					
	'H' & 'W'		'D'		'T'	
G-8	1/4"	6.4mm	11/32"	8.7mm	.050	1.3mm
G-12	3/8"	9.5mm	1/2"	12.7mm	1/16"	1.6mm
G-16	1/2"	12.7mm	11/16"	17.5mm	1/16"	1.6mm
G-20	5/8"	15.9mm	7/8"	22.2mm	3/32"	2.4mm
G-24	3/4"	19.1mm	1-1/32"	26.2mm	3/32"	2.4mm
G-28	7/8"	22.2mm	1-7/32"	31.0mm	1/8"	3.2mm
G-32	1"	25.4mm	1-13/32"	35.7mm	1/8"	3.2mm

STRUCTURAL FITTINGS

LADDER CLIPS

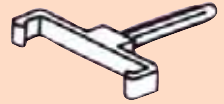

Use for securing Ladders against structures and other towers. Designed for adjustable clearance from the mounting surface by simply trimming the stem length. Use SX as mounting device or drill 1/16" hole (1.6mm) Precision Injection Molded in Clear Acrylic Plastic.

CODE	TO FIT LADDER	SX SIZE	STEM O.D.
LC-8	8	SX-2	1/16" 1.6mm
LC-12	12	SX-3	3/32" 2.4mm
LC-16	16	SX-3	3/32" 2.4mm
LC-24	24	SX-3	3/32" 2.4mm

CONSTRUCTION STUDY FITTINGS & KITS

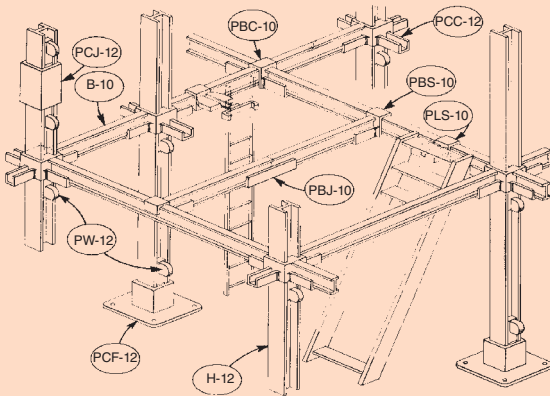

The Construction Study System and Fittings allows designers to facilitate the structural arrangement and layout of equipment and structures in preliminary form and educators to demonstrate structure design and strength in three dimensions. This quick and easy to use, and re-use, system provides complete flexibility and is presented solely as a design tool - a method of thinking and expressing in three dimensions. All parts are precision Injection Molded in Dark Gray ABS Plastic. The components are designed to work only with our H-12 and B-10 structural members.

Available both in Kit form or by individual products. Kits include a selection of the below components as well as scale figures and other definitive scale parts to construct the diagram at left.

CODE	SCALE
KIT-5029	1/4" = 1'-0" 1:48
KIT-5030	3/8" = 1'-0" 1:32
KIT-5031	1/2" = 1'-0" 1:24
KIT-5032	3/4" = 1'-0" 1:16

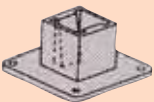

Column Footer
CODE: PCF-12

Provides a firm support for H-12. May be temporarily positioned with double stick tape. Use PW-12 for secure fit.

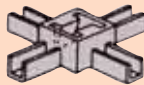

Column Cross
CODE: PCC-12

Provides a quick and easy way to attach B-10 cross members to H-12 columns. Use PW-12 for secure fit.



Column Splice
CODE: PCJ-12

Provides a quick and easy way to attach two H-12 columns together. Use PW-12 for secure fit.



Column Wedge
CODE: PW-12

Acts as a locking wedge for securing the Column Footer, Column Cross or Column Splice to the column.

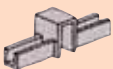

Beam Cross
CODE: PBC-10

Snaps over primary B-10 members to allow easy installation of secondary B-10 members.



Beam Support
CODE: PBS-10

Snaps over primary B-10 members to allow easy installation of secondary B-10 members.

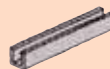

Beam Splice
CODE: PBJ-10

Provides a firm support for joining two B-10 members together.



Ladder Support
CODE: PLS-10

Provides a firm support for a ladder or stair by snapping over a B-10 member.